

Article number: 25.1400B.BL.3

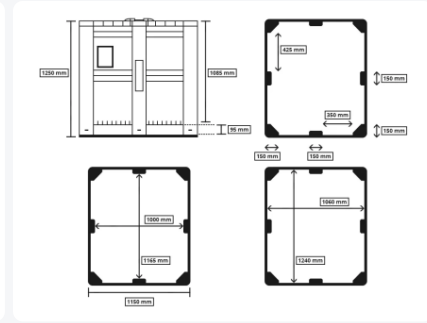

Pallet box type MAXI BOX - 1300 x 1150 x H1250 mm - perforated - 3 runners - blue

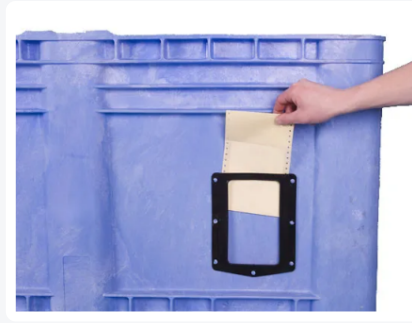

Product specifications

External dimensions (L x W x H)	1300 x 1150 x 1250 mm
Internal dimensions (L x W x H)	1240 x 1060 x 1085 mm
Capacity	1400 liter
Sidewalls	Perforated
Material	HDPE
Article number	25.1400B.BL.3
Weight (kg)	73,5 kg
Color	Blue
Bottom	Perforated, reinforced
Max. load capacity per box	1000 kg
Max. static stacking load	7000 kg
Max. dynamic stacking load	2000 kg
Quantity per pallet	2

Properties

MAXI BOX plastic pallet box, dimensions - 1300 x 1150 x H1250 mm - 1400 liter

With perforated side walls and base

Fitted with 3 pallet runners - solid, replaceable

Equipped with substantial vertical columns for high load capacity

The maximum stacking load is 7000 kg (the maximum load on the bottom box)

With smooth inner walls and outer walls without many rib structures - for easy emptying and cleaning

Fully food-grade and easy to clean

MAXI BOXES are highly suitable for heavy and intensive use with large volumes

The load capacity of 1000 kg speaks for itself

MAXI BOXES stack with stacking rims on top of the box

Equipped with label holders on both long sides (label size: 145 x 250 mm - wxh)

100% recyclable and circular

Options: lid - printing - QR codes and barcodes - colours - perforated version - version with 6 pallet runners (window version)

Description

Size and performance

MAXI BOX plastic pallet boxes are pallet boxes in a class of their own - both because of their size and their performance. With a capacity of 1400 litres, the box even exceeds agricultural bulk bins. The MAXI BOX is highly suitable for the storage and transport of these large volumes. Each box can be loaded up to 1000 kg, while the static stacking load is 7000 kg.

The construction

The MAXI BOX derives its stability mainly from the vertical columns in the side walls. These columns are clearly visible on the outside and extend slightly into the interior. This results in a high stacking load and very strong walls that can withstand substantial lateral pressure. That is why the performance is so impressive. Despite this construction, the MAXI BOX is very easy to clean and hygienic. External ribs are largely absent.

Perforated and ventilated

In the perforated version of the MAXI BOX, both the walls and the base are perforated. This variant is mainly used for the storage and transport of agricultural products, meaning fruit and vegetables. The perforations provide good ventilation for these products, helping them stay fresh for longer and allowing them to be cooled optimally. The perforated base also ensures drainage of moisture and possible condensation. For this application, our MAXI BOXES are exactly in their element.

Applications

MAXI BOXES are made of food-grade HDPE. This plastic also makes the box highly impact-resistant. As a result, the MAXI BOX is used in many sectors - from agriculture to recycling and from the food industry to logistics - wherever large volumes and heavy loads need to be stored and transported.



Matching accessories



Alternative articles

